

Read these instructions before commencing installation & retain them for future reference.

IP44   **240V**

These Sensors are Class II and do not require an Earth connection

Important Information

It is recommended that luminaires are installed and fitted by a qualified electrician ensuring the installation complies with current IEE wiring regulations & local building control. These products are designed for connection to a 240V 50Hz supply. Any broken or damaged parts should be replaced as soon as possible. KSR will not accept responsibility for any claims arising from a poor installation.

Installation Guidelines

These sensors can be wired through two blank grommets (2x16mm). Remove the sensor from the back box, use a small flat blade screwdriver to tease the two pieces apart as per Fig 1
Dress the cables through the back box and secure to suitable surface.

Terminate your mains input cable into the L (Brown) & N (Blue) terminals, then connect the luminaire wires into the L' (Red) & shared N (Blue) terminals on the sensor.

On initial installation it is advised you leave the time setting to 10 Seconds and the Lux setting on the 'sun' symbol. This will allow you to test and set up the sensor as required.

Time - This sensor can switch the lighting from a minimum of 10 Seconds to a maximum of 15 minutes, carefully turn the time dial to the required time.

Lux - This sensor will activate between daylight and 3 Lux, in order to achieve the required 'on' time it is recommended that the sensor is set to 30 Lux and wait 24 hours, after this period you can adjust the Lux control to up or down accordingly.

Position - Ensure you position the sensor in a location suited to the the required activation point, this may not be central to any space. Avoid placing the sensor near heating vents or highly reflective surfaces as this may cause unwanted triggering.

PIR Specification:

- Mains Input - 220-240v AC
- Lux Control - 3-2000 Lux Adjustable
- Time Setting - Min 10 Seconds +/- 3 Second
Max 15 Minutes +/- 2 Minutes
- Rated Load - LED, 400W
Halogen, 800W

- Detection Area - 180°
- Detection Distance - 12m Max
- Parasitic Power - 0.5W
- Installation Height - 1.8 - 2.5m

Fig 1.

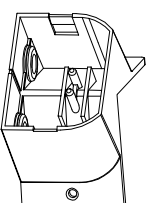
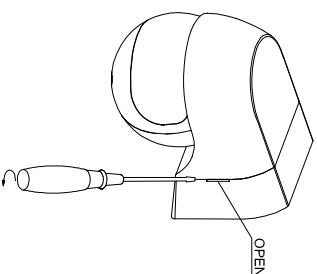

Optional Corner Bracket (supplied)

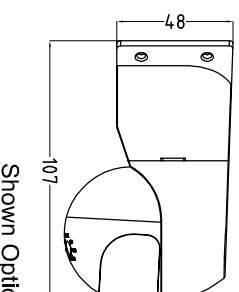
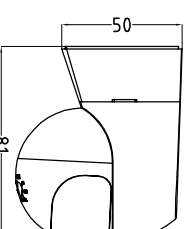
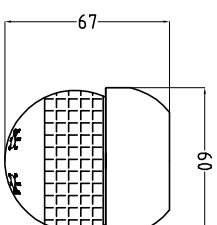
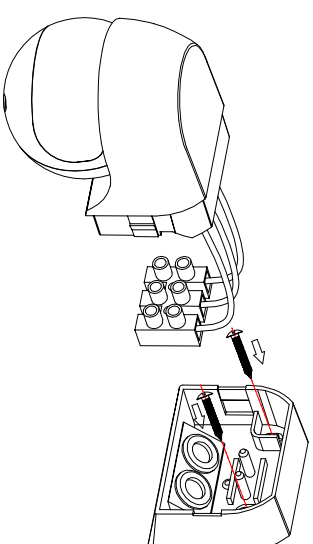

Shown Optional Corner Bracket

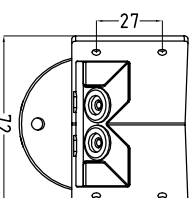

Shown Optional Corner Bracket

Manually override the sensor by switching the wall switch twice within 5 seconds. This will override the sensor for 8 Hours then it will revert back to automatic control.

Mains Supply



Out to Luminaire

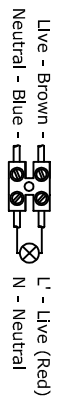

Available finish:- White Finish